

Wi-Fi Plug 数采器 快速安装指南



iOS



Android

1. 电气连接

- ① 将数采器的串口与逆变器的串口对齐，插紧。
- ② 用螺丝把数采器固定在逆变器上。
- ③ 确认数采器各指示灯状态（外壳上有绿色LED灯光透出为正常）。

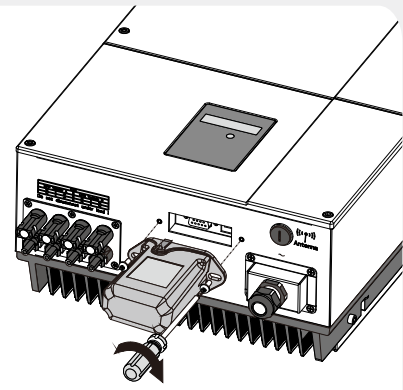
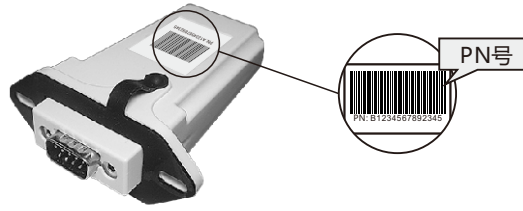

2. 无线路由器连接

2.1 APP下载

- ① 扫描快速安装指南封面上的二维码，下载APP。
- ② 打开APP，点击“Wi-Fi配置”按钮，进入“Wi-Fi配置”页面。

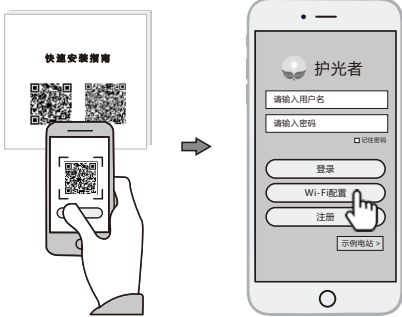

2.2 连接Wi-Fi数采器

- ① 在“Wi-Fi配置”页面，点击“连接Wi-Fi数采器”按钮（安卓手机不需此步骤）。
- ② 找到与数采器PN号相同的Wi-Fi进行连接（初始密码：12345678）。

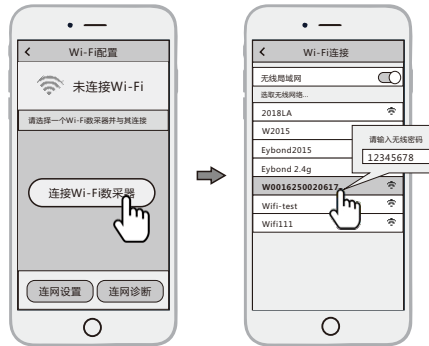

2.3 连网设置

- ① 点击“连网设置”按钮，进入该界面。
- ② 填写相关信息，完成连网设置。
- ③ 断开2.2步骤所连接的数采器Wi-Fi。
- ④ 重新连接可上网的Wi-Fi热点或运营商网络。



3. 注册账号与创建电站

3.1 注册账号

- ① 在APP首页，点击“注册”按钮，按提示填写相关信息，完成注册。



3.2 创建电站

- ① 登录APP，选择“列表”菜单。
- ② 点击右上角的“+”按钮，进入到“创建电站”页面。
- ③ 根据提示输入相关信息，完成电站创建。



2.3 添加多个数采器设备

注意：一个账号可创建多个电站，一个电站可添加多个数采器，如果您只有一个数采器，则不需此步骤。

- ① 点击已经建好的电站，进入该电站主界面。
- ② 选择“设备”菜单，点击右上角的“+”按钮，进入到“添加数采器”页面。
- ③ 扫描数采器的PN号，添加数采器；如果扫描不成功，可以手动输入。

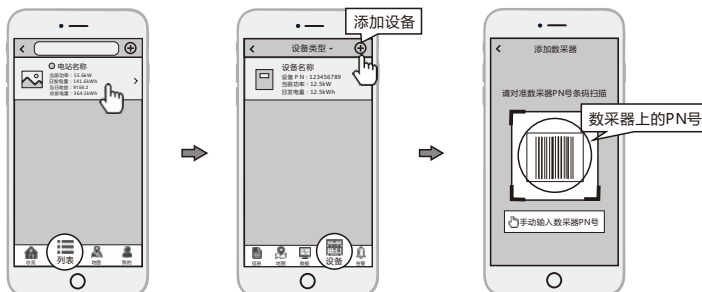

备注：除护光者APP外，您可以通过微信小程序实现电站的远程监控。



微信扫一扫，使用小程序

- 无需下载 即开即用
- 节省流量 自动更新
- 电站分享 好友互动

Wi-Fi Plug

Quick Installation Guideline



iOS



Android

1. Installation

- Align the serial port of the Wi-Fi Plug with the inverter and plug it in tightly.
- Fasten the Wi-Fi Plug to the inverter with the screw.
- Confirm the status of the LED indicator (When you saw the green LED light turn on from the shell, showing the normal working status).

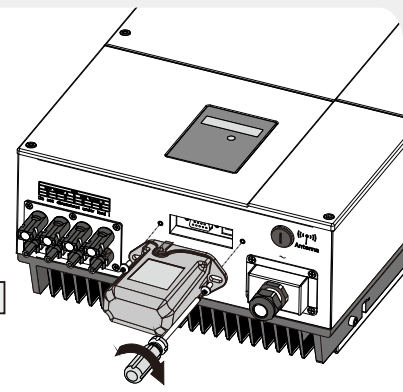
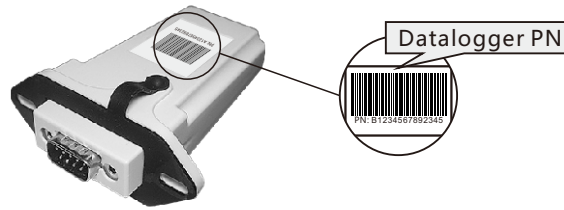

2. Wireless Router Connection

2.1 Download APP

- Scan the QR Code from the cover of this guideline and download the APP.
- Open the APP, tap the **Wi-Fi Config** button to enter this page.

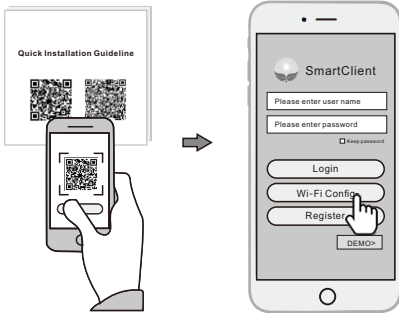

2.2 Connect Wi-Fi Datalogger

- Tap the **Connect Wi-Fi Datalogger** button on the Connected page. (Android phone has no need of this step).
- Select the same number of Wi-Fi Plug PN to connect. (Initial Password: 12345678)

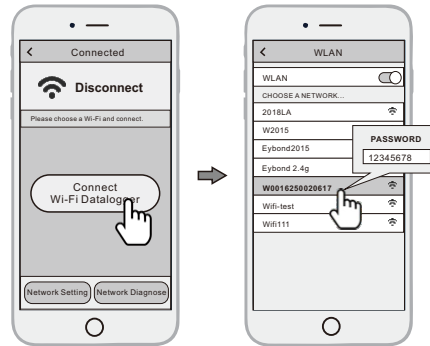

2.3 Network Setting

- After the connection completes, tap the **Network Setting** button.
- According to the prompts, type in the information to finish the network setting.
- Reconnect the Wi-Fi or Cellular Data which can surf the Internet instead of the Wi-Fi connected by step 2.2.

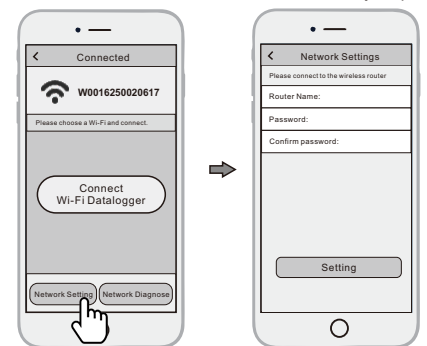

3. Create Account And Plant

3.1 Create Account

- Open the APP, tap the **Register** button.
- According to the prompt information, complete creating an account.

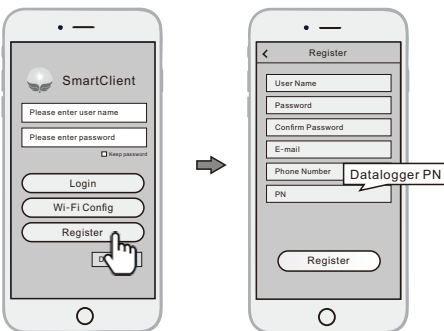

3.2 Create Plant

- Login the account and click the **list** button on the bottom of the home page.
- Tap the "+" button on the top-right corner of the list page.
- According to the prompts, type in the information to finish creating plant.

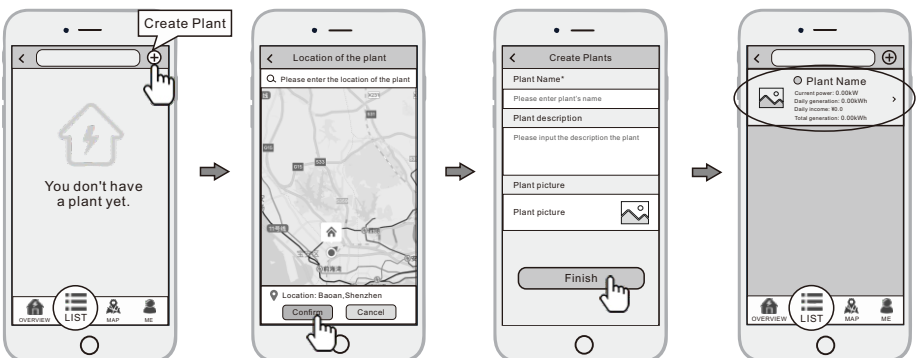

3.3 Add Multiple Dataloggers

Note: One account can create multiple plants and one plant can add multiple dataloggers. If you only have one datalogger, you can ignore this step.

- Tap the new plant you just created, and enter its home page.
- Click the **Device** button on the bottom of the home page.
- Tap the "+" button at the top-right corner to add the datalogger.
- Scan the datalogger PN on the Wi-Fi Plug, or input it manually.

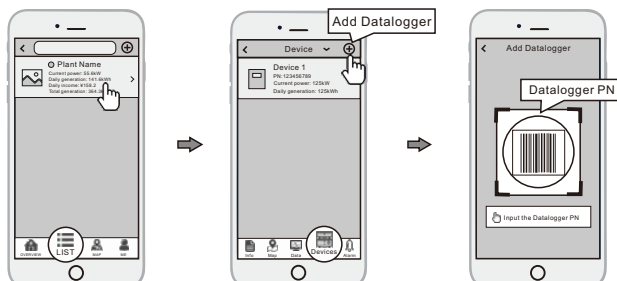

Note: Besides the SmartClient APP, you're also can remote monitoring your plants by using WeChat mini program.



Scan the Wechat QR code to use the mini program.